

INSTALLATION AND USER INSTRUCTION GUIDE

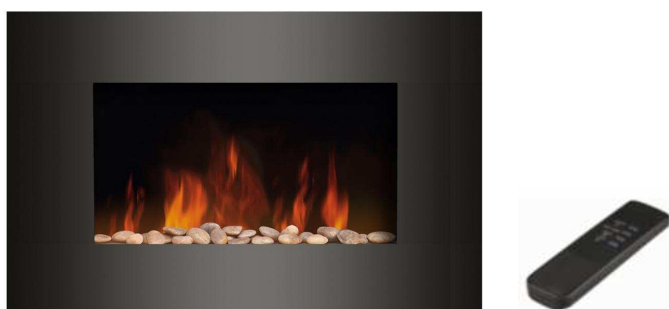

Electric Fire With Remote Control Model : CHE420 / CHE422 / CHE430

Please read all instructions carefully and retain for future
reference

**IMPORTANT : THESE INSTRUCTIONS SHOULD BE READ CAREFULLY AND
RETAINED FOR FUTURE REFERENCE.**

WinEurope - FRANCE

Web : www.purline.com

Important Safety Instructions

When using this electrical appliance, basic precautions should be followed to reduce the risk of fire, electric shock, and injury to person, including the following:

- This heater must be used on an AC supply only and the voltage marked on the heater must correspond to the supply voltage.
- Do not switch the appliance on until it properly installed as described in this manual.
- The heater must not be located immediately below a socket outlet.
- Keep furniture, curtains and other flammable material at least 1 meter away from the appliance. Never closed to curtains and other combustible material, otherwise may cause risk
- Do not leave the appliance unattended during use.
- Do not leave the appliance unattended whilst connected to the mains supply.
- Keep out of reach of children and do not allow them to operate this appliance.
- This appliance is intended for household use and should not be used for industrial Purposes.
- From time to time, check the cord for damage. Never use the appliance if the cord or any part of the appliance shows signs of damage.
- Do not operate this appliance with a damaged plug or cord, after a malfunction or after Being dropped or damaged in any way.
- Repairs to electrical appliances should only be performed by a qualified electrician. Improper repairs may place the user at serious risk.
- Do not run the mains cable under carpets, rugs etc.
- Do not allow the mains cable to hang over sharp edges or come into contact with hot surfaces.
- **WARNING:** In order to avoid overheating, do not cover or obstruct the heater in any way.
- Overheating will result if it is accidentally covered.
- Never immerse the product in water or any other liquids.
- Do not use this heater in the immediate surroundings of a bath, a shower or a swimming pool.
- Do not use the appliance outdoors.
- Do not use if you have wet hands.
- Never use the appliance on or near hot surfaces.
- Do not operate with a damaged cord.
- Before cleaning the appliance, ensure it is unplugged from the power and that it is Completely cooled.
- Do not clean the appliance with abrasive chemicals.
- Never use accessories that are not recommended or supplied by the manufacturer. It could cause danger to the user or damage to the appliance.
- The only user replacement parts are the bulbs. There are not other user replacement parts. All other servicing should be referred to a qualified engineer.
- This appliance is not intended for use by persons (including children) with reduced Physical, sensory or mental capabilities, or lack of experience and knowledge unless they have been given supervision or instruction concerning use of the appliance by a person responsible for their safety.

- Children should be supervised to ensure that they do not play with the appliance.
- Do not lift the appliance by the front panel.

CAUTION: In order to avoid a hazard due to inadvertent resetting of the thermal cutout, this appliance must not be supplied through an external switching device, such as a timer, or connected to a circuit that is regularly switched on and off by the utility.

Warning:

- In order to avoid overheating, do not cover the heater.
- The heater must not be located immediately below a socket outlet.
- Do not use this heater with a programmer, timer or any other device that switches the heater on automatically, since a fire risk exists if the heater is covered or positioned incorrectly.
- Do not use this heater in the immediate surroundings of a bath, a shower or a swimming pool.
- This appliance is not intended for use by persons (including children) with reduced physical, sensory or mental capabilities, or lack of experience and knowledge, unless they have been given supervision or instruction concerning use of the appliance by a person responsible for their safety.
- Children should be supervised to ensure that they do not play with the appliance.

Getting Started

- Remove the appliance from the box.
- Remove any packaging from the product.
- Place the packaging inside the box and either store or dispose of safely.

Contents of Carton

- Heater.
- Wall fixing bracket.
- Fixing screws and wall plugs.
- Remote control.
- 1 Instruction Manual.

Helpful Advice Before Fitting

- Please retain all packaging until you have checked and counted all the parts and the contents of the fixing pack against the parts list.
- The fixing pack contains small items which should be kept away from young children.
- We suggest that you open the fixing pack and place all the contents into a container, therefore reducing the risk of losing any small pieces.

Installation (see Fig. 1~Fig. 4)

- Do not connect the appliance until properly fixed to the wall and the instructions is read fully.
- The minimum distances must be observed.
- For installation of the appliance, care must be taken not to damage concealed cables.
- Please be careful while drilling the holes.
- This appliance is designed to be permanently fixed to a wall at a minimum height of 300mm. The wall bracket must be fitted horizontally and the cable routed to the bottom right of the heater.

- A height of 600mm from bottom of heater to floor is recommended for optimum viewing of fuel bed—see Fig.2 for recommend fixing dimensions—.
- For optimum viewing, mark the top four screws fixing positions on wall in accordance with the recommend fixing dimensions- see Fig.2.Drill holes with a six drill bit.
- Fix the wall bracket using that the plug and screws provided .
- Carefully lift the heater up ensuring that the top rear ledge of heater engages the wall bracket (see Fig.2 in circle) and is sitting centrally.
- Gently bring the heater level with the wall.
- Mark the bottom holes position-see Fig.3, remove the heater ensuring that the bottom fixing bracket is rotated up.
- Drill and fit wall plug.
- Refit the heater to the wall fixing bracket and rotate the bottom fixing bracket down again and use the screw provided to permanently fix the heater in place.
- Unpack the pebbles from the bag and place them along the light unit in the desired Position.
- Place the front glass surround over the front of the fire aligning the slots in the brackets at each side of the glass panel with the lugs on the sides of the fire-see Fig.4. Again two people will be required for this operation.

Replacing the Lamp (see fig. 5 and fig. 6)

- **Warning**-Always disconnect from the power supply before removing bulb.
- **Warning**-The bulbs reach high temperatures during operation. Allow the bulbs to cool down after switching off the appliance before changing lamps.
- **Note**: Two people will be required for this process.
- It is recommended that the fire is carefully removed from the wall and laid on its back in order to replace the lamp.
- Gently slide the front glass panel towards the top of the fire and remove. Store the glass safely out of the way whilst the bulb is replaced so that it does not get damaged.
- **At the bottom of fire, there is a lamp cover fixed by eight Philip's head screws, remove the eight screws and lift off the lamp cover-see Fig.5. (for CHE430)**
At the bottom of fire, there is a lamp cover fixed by four Philip's head screws-see Fig. 5, remove the four screws and lift off the lamp cover. (For CHE420 / CHE422)
- For access to the bottom bulbs, carefully slide the flexible rotisserie to one side ensuring that the rubber grommet is not lost-see Fig.6
- Remove the defective bulb by unscrewing it.
- Replace with a 40W E14 SES Clear Candle bulb, rotating it. Take care not to over-tighten the bulb.
- Refit the rotisserie making sure that the rubber grommet is carefully pushed into the slotted hole on the axial bracket.
- Lift the fire back onto the wall and replace the glass front by lifting onto the lugs either side of the fire.

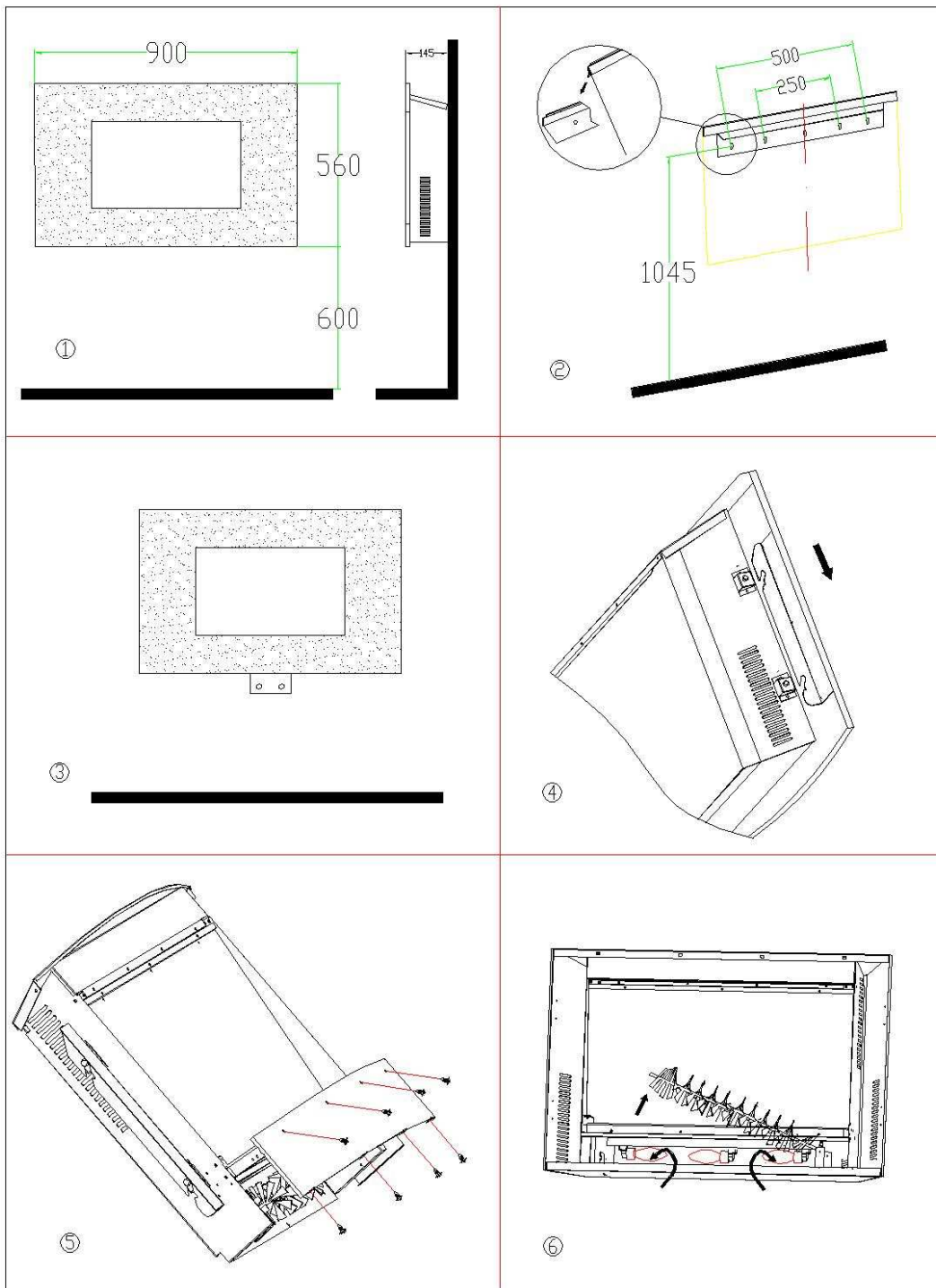

Figure 1~6 (CHE430)

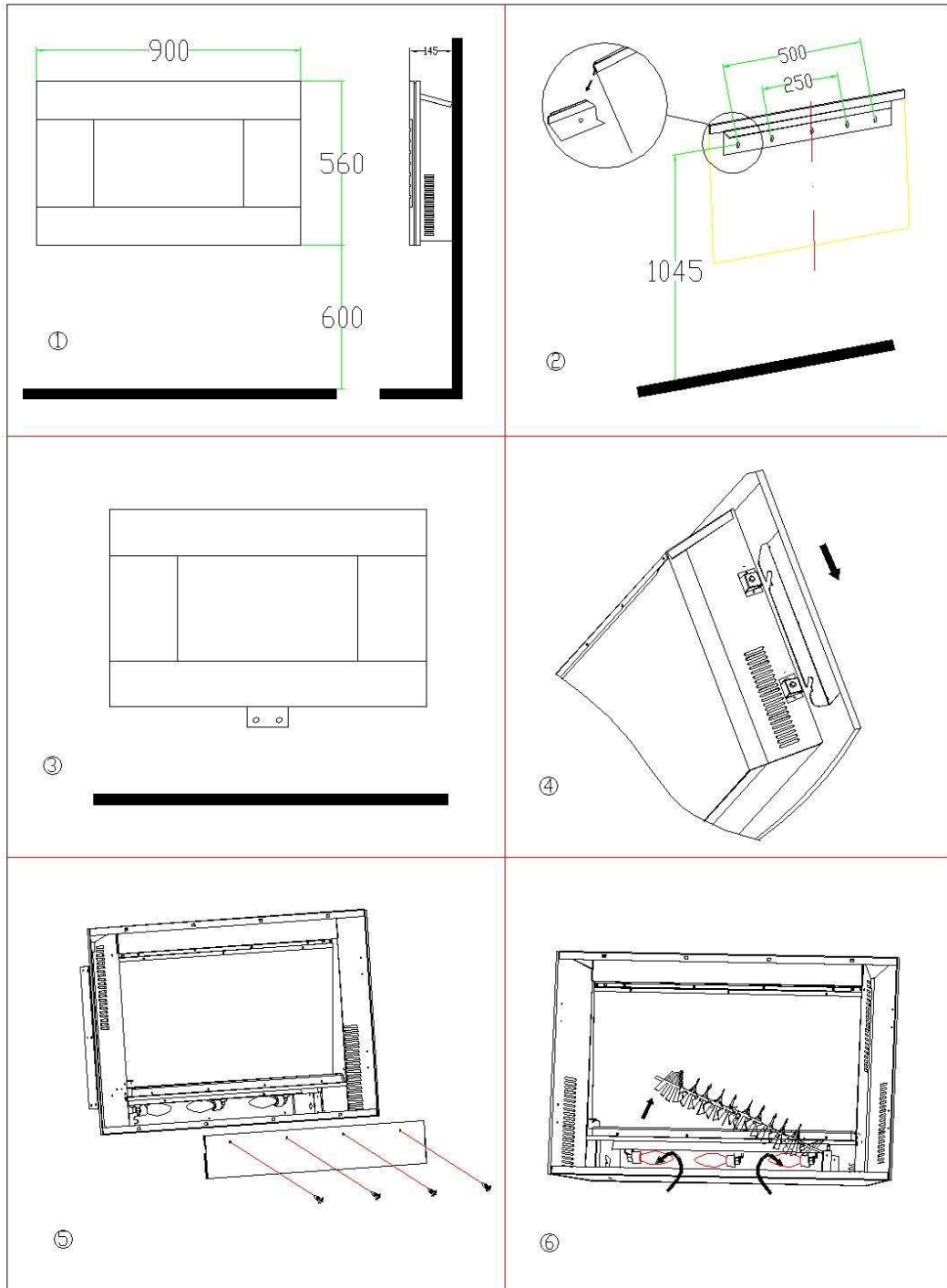

Figure 1~6 (CHE420 / CHE422)

Instructions for Use

- The appliance can be operated either by the switches located on the top right hand side of the fire or by supplied remote control.

Manual Operation

- The switches located at the top right hand side of the fire .The standby switch must be first switch on..
- Press once the O/I button to turn on the appliance and fire effect.. A red indicator light will appear to indicate that the function is ON. Press the O/I button for 3 seconds this will operate the dimmer mode.
- Press once the 1000W button for the low heat settings; press twice to switch off the heat setting.
- Press once the 2000W button for the high heat settings; press twice to switch off the heat setting.

Remote Operation

- The standby switch located at the top right hand side of the fire must be first switch on..
- It takes some time for the receiver to respond to the transmitter. Do not PRESS the buttons more than once within two seconds for correct operation.
- Press once the button ON/OFF on the remote control this turns ON/OFF the appliance and fire effect.
- Press once the 1000W button for the low heat settings; press twice to switch off the heat setting.
- Press once the 2000W button for the high heat settings; press twice to switch off the heat setting.
- Press the DIMMER button for operate the dimmer mode.

Safety Cut-Off

- This appliance is fitted with a safety cut-off which will operate if the fire overheats (eg. due to blocked air vents). For safety reasons, the fire will NOT automatically reset.
- To reset the appliance, disconnect the appliance from the mains supply for at least 15 minutes. Reconnect the supply to the mains and switch on the appliance.

Troubleshooting

Symptom	Solution
No operation/ no fan.	Check fuse by replacement. Check for safety cut-off operation.
No fire effect light.	Check the bulb by replacement.

Cleaning

- **Warning**-Always disconnect from the power supply before cleaning heater
- For general cleaning use a soft clean duster-never use abrasive cleaners. The glass viewing screen should be cleaned carefully with a soft cloth. DO NOT use proprietary glass cleaners.

Technical Specification

- Supply: 220-240V~ 50Hz
- Rated power: 2000W
- Lighting: 40W E14 SES Clear Candle bulb

❖ Characteristics prone to change without notice

Warranty :

The warranty is valid for 1 year for a « manufacturing fault ».

To benefit from the warranty, please return the device to your dealer with POSTAGE PAID along with the document of purchase proof specifying the date of purchase.



Meaning of crossed –out wheeled dustbin:

Do not dispose of electrical appliances as unsorted municipal waste, use separate collection facilities.

Contact you local government for information regarding the collection systems available.

If electrical appliances are disposed of in landfills or dumps, hazardous substances can leak into the groundwater and get into the food chain, damaging your health and well-being.

When replacing old appliances with new ones, the retailer is legally obligated to take back your old appliance for disposals at least free of charge.